

Multiple Displays - Explained

PC Screen Only: This means that images will only display on your primary monitor and that any secondary display will not function.



Duplicate Display: This configuration will display identical images on both monitors connected to your PC.



Extend Display: When you extend your display, it adds the second monitor as extra screen space.



Second Screen Only: This configuration will only display on one monitor. This particular configuration will blackout the main display

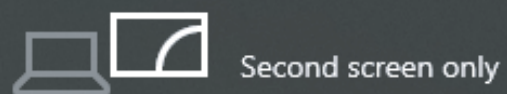

This is the default setting for you PC. If plugging into a TEC Pack, use duplicate or extend otherwise your TEC Pack will display black.

This is best used when you want to show students something on a TEC Pack and follow along on your PC screen.

Best used for showing a class something on the TEC Pack while you work on something privately from students. You may need to drag a window to the edge of your screen to see it on your TEC Pack.

This is best used if you prefer to use your TEC Pack or another monitor as your sole display. This will make your Laptop screen black.

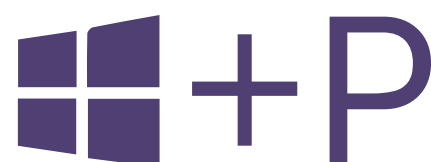

There are multiple display configurations your computer can operate while using dual monitors. Each layout has specific uses, and you can switch between all configurations easily by pressing the windows + p key combination.

Multiple Displays - Settings

navigating to settings

1. select the start menu
2. next, click settings

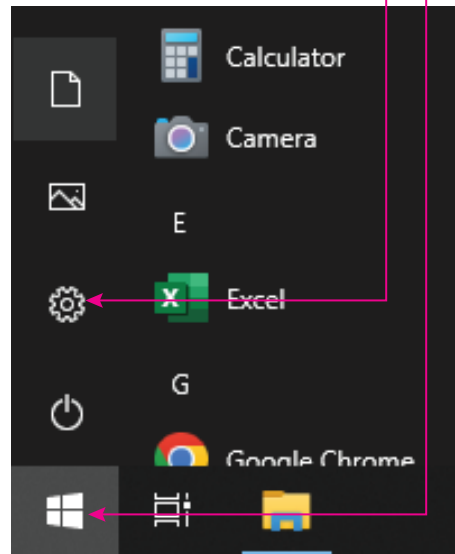

select display settings

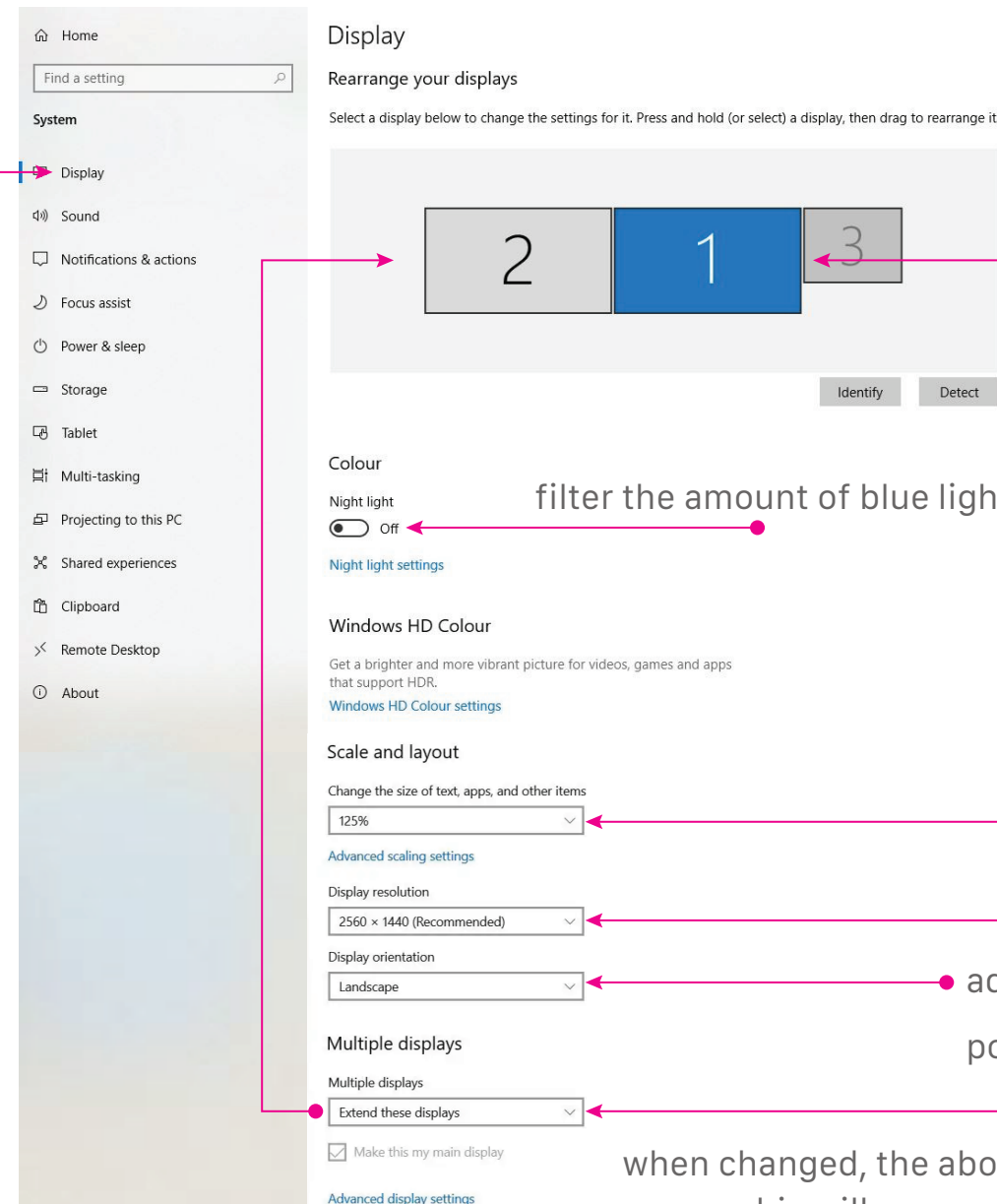

select the display that you would like to adjust

filter the amount of blue light emanating from your display- default is 'off'

increase to make icons and text larger

adjust your resolution to fit everything on your screen (SMARTBOARDS)

adjust when using a portrait monitor

when changed, the above graphic will represent your selection

having sound issues

1. click the speaker in the system tray (bottom right of your desktop)
2. select EPSON PJ for sound to come from the TEC Package speakers
3. select Speaker (Conexant ISST) for audio to come from your laptop speakers

